

AS Core Training Course

DVM

Yu-Huei Chen(陳昱卉)

April 2020 Revised



Outline:

- **Organization Structure and Facility Plan**
- **Application for Experimental Animals**
- **Application for Users**



Outline:

- **AS core's organization structure and facility plan**
- Application for Experiment Animals
- Application for Users



Introduction

Purpose:

Providing the husbandry service of **SPF laboratory animal** for Academia Sinica

Location:

Institute of Biomedical Science, New Building 10F

(1) Area A : A total of 1800 cages

(2) Area B : A total of 980 cages

B1: Recovery room : 280 cages + Operation room

B2: Breeding room : 700 cages

(3) Q room

Veterinarian : DVM Yu-Huei, Chen



The plan of AS core

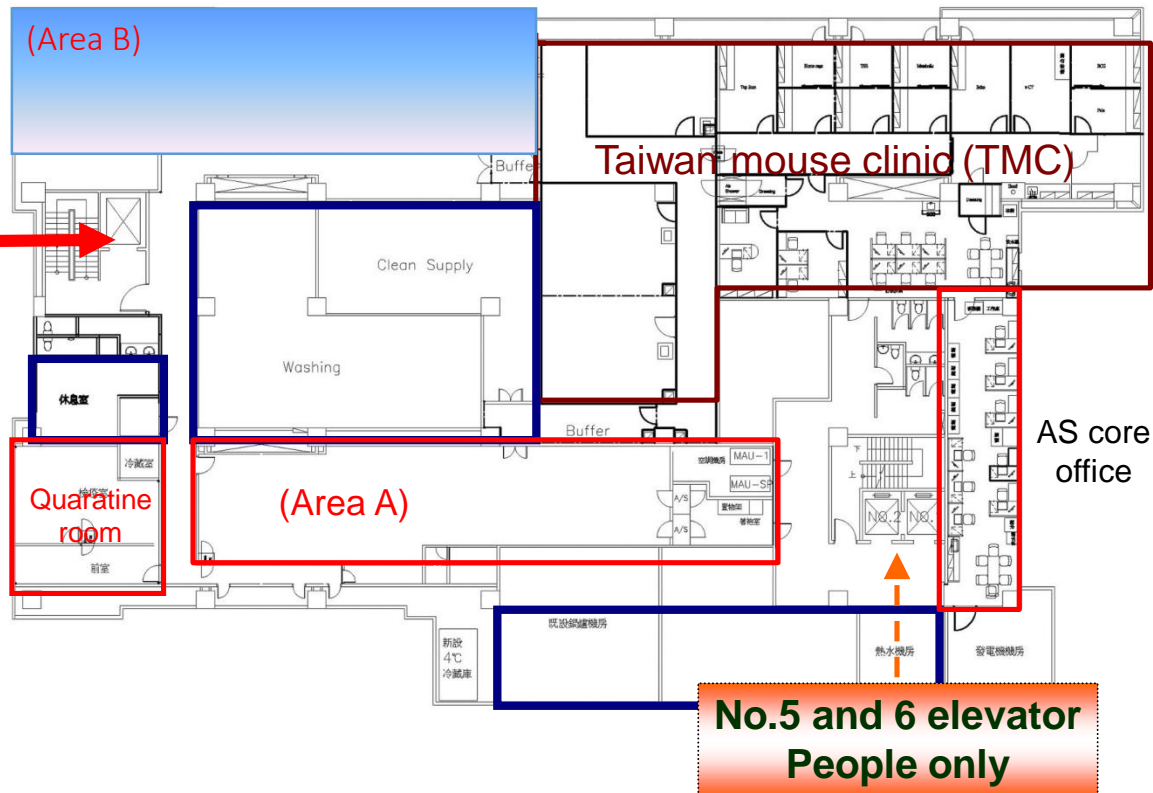

Rules for the usage of cages

- (1) Each PI can hold **a maximum of 100 cages** in Area A and **a maximum of 50 cages** in Area B.
- (2) When the facility usage rate is **less than 85%**, PI is allowed to **temporarily** apply for excess cages. If the facility usage rate is reaching or **above 85%**, AS core will request PI to return the excess cages within 2 months. If the return process is over 2 months, **each cage will be charged twice the usual price.**



The usage of cages :

(3) Users will be suspended **temporarily** if there's no access records in over **3 months**. Users will be suspended **permanently**, if there is no entry records in over **6 months**. Users need to re-take the training course to regain the pass.

(4) The usage and the charge of the cages are based on **the filling date of application form**. Every vacant cages is belonged to AS Core. AS Core has authorization to move or to assign the cages. All applications required **3 working days in advance**.

(5) Users can choose either area A or are B. Animals from area A can be transferred to area B.



Outline:

- AS Core's Organization chart and Spatial Planning
- **Application for Experiment Animals**
- Application for Users



Experimental animals application procedure

Submit the project to IACUC and get the approval number



Check with AS Core if there has vacant cages.



Submit the application and animal health monitoring report
(from the original source) on AS Core Website

<http://ascore.sinica.edu.tw> at least 3 working day before



Review by AS Core

Accept

Decline

**Scheduled a time with
veterinarian.**

Suggest Pathogen Free Rederivation (by NLAC).

Failed

After Pathogen Free Rederivation (by NLAC)
The animals are accepted to all area of AS Core

Transfer the animal to IBMS,
New Building 10F via No.7
elevator and put the cage into
the stainless cabinet



Animals were subjected to quarantine.

Takes **1-2 months**

Pass.
Animals accepted.



<http://ascore.sinica.edu.tw/>



Academia Sinica **SPF animal facility**

- 繁體中文
- English

Home

About us

Regulation

Cage Information

NEWS

Download

Report

Online application

New message

Health report



**AS Core
Management System**



**2018 AS Core education
training course ppt file**



Q & A



schedule

AS Core Notice-Working Suit Recycled

10 April 2020 cyhwtr2

AS Core Notice

Starting from April 13th, 2020, the work suit for animal rooms in all area should be folded and recycled according to the following steps. If you have any question please contact the veterinarian. (Yu-Huei Chen cyhwtr@gate.sinica.edu.tw 02-2789-9911#103 or #114)



Registration

Register

Authorized
email

Wait for
Authorization



Change to English version

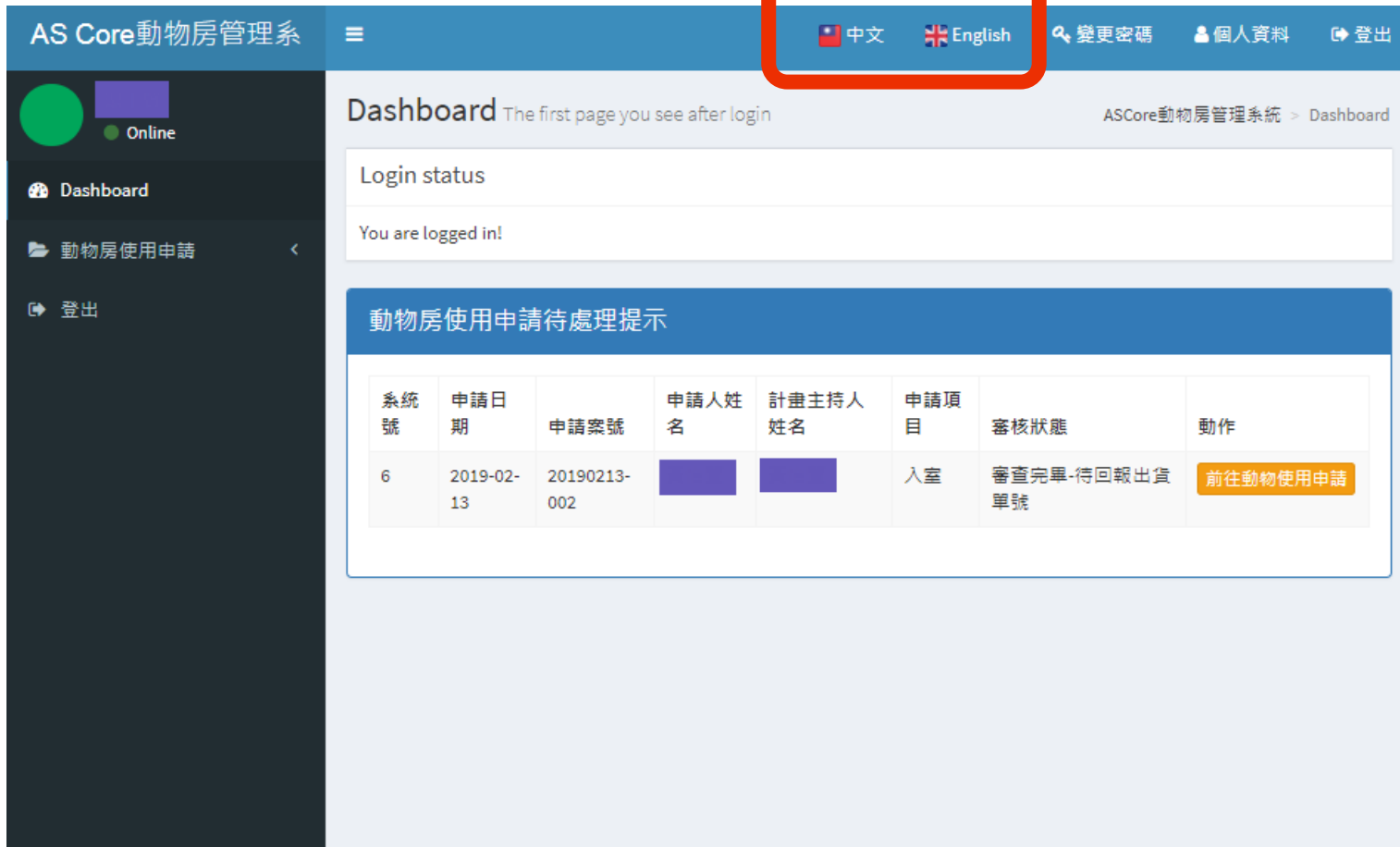

The screenshot shows the AS Core Animal Room Management System dashboard. The top navigation bar includes the system name, a menu icon, and language options: 中文 (Chinese) and English. The English option is highlighted with a red box. Other navigation items include 變更密碼 (Change Password), 個人資料 (Personal Information), and 登出 (Logout). The main content area displays the user's login status and a table of pending animal room usage applications.

AS Core動物房管理系

中文 English 變更密碼 個人資料 登出

Dashboard The first page you see after login

ASCore動物房管理系統 > Dashboard

Login status

You are logged in!

動物房使用申請待處理提示

系統號	申請日期	申請案號	申請人姓名	計畫主持人姓名	申請項目	審核狀態	動作
6	2019-02-13	20190213-002			入室	審查完畢-待回報出貨單號	前往動物使用申請



Application

AS Core動物房管理系

湯賢賢 Online

Dashboard

動物房使用申請

入室申請

新增歸還轉移

線上簽核清單

助理申請清單

登出

中文 English 變更密碼 個人資料 登出

入室申請

+ 新增 入室申請

每頁 25 項紀錄 搜尋:

申請案號	申請人姓名	計畫主持人姓名	申請日期	IACUC NO.	品系	審核狀態	動作
資料庫中沒有相關紀錄							

正在顯示 0 個紀錄中的 0 至 0 項

上一頁 下一頁

AS Core management

湯賢賢 Online

Dashboard

AS Core Application

Housing area application

New/Return/Transfer

Online approval list

RA application list

Logout

中文 English Change password Profile Logout

Housing Area Application

+ Add Cage application

25 records per page Search:

No. of application	Name of user	Name of PI	Date of application	IACUC NO.	Strain	Review Status	Next
No data available in table							

Showing 0 to 0 of 0 entries

Previous Next

Housing area application

Step1: User/PI information

Qualification

Applicant must be qualified as following:

- pass the lecture test
- Pass either A or B area practical course
- Had experience with animal facility within 6 months
- If applicant is not a PI, please select RA for the application

Qualification Instruction

申請人Applicant

Name *

E-mail *

Position/Title *

Contact number *

Emergency number *

計畫主持人Principle Investigator

PI *

IACUC NO. *

Select IACUC protocol and approval number

< Back Next >



Housing area application

Currently registered cages status

第二步: 填寫申請項目

主持人於各區登記及使用總籠數

A 區	登記籠數 : 7	使用中籠數 : 5
B1 區	登記籠數 : 14	使用中籠數 : 14
B2 區	登記籠數 : 12	使用中籠數 : 12
B3 區	登記籠數 : 10	使用中籠數 : 0
Q 區	登記籠數 : 0	使用中籠數 : 0

申請人 : 湯賢賢 , 有實習的區域 : A, B

計畫主持人 : 湯于賢

計畫 : iacuc-107003 湯于賢的計畫



Housing area application

代發動物資料Animal Information

Animal information

Strain * full name

Sex-Number * male write down 0 as none 隻 female write down 0 as none 隻

Date of Birth 📅

Age

If animals are different age in one cage, please fill in this column

Note

Number of cage * Fill in the number greater than 0

Source of animal * NLAC LASCO Re-derived mice others

Attachments [+ Attach file](#)

Date of importation * 📅

Invoice Number

Acqusted area * A-Breeding area B2-Husbandry area B1-Recovery area (room) B3
※Animals from NLAC/Lasco can be transferred to B directly with health report.
※housing area must match to the applied area on the original application form.

New cage number Fill in the number greater than 0

Special request



New/Return/Transfer

AS Core 動物房管理系統

湯賢賢 Online

Dashboard

動物房使用申請

- 入室申請
- 新增歸還轉移**
- 線上簽核清單
- 助理申請清單

登出

新增歸還轉移

+ 新增 新增歸還轉移

每頁 25 項紀錄

搜尋:

申請案號	申請人姓名	計畫主持人姓名	申請日期	審核狀態	動作
資料庫中沒有相關紀錄					

正在顯示 0 個紀錄中的 0 至 0 項

上一頁 下一頁

AS Core management

湯賢賢 Online

Dashboard

AS Core Application

- Housing area application
- New/Return/Transfer**
- Online approval list
- RA application list

Logout

New/Return/Transfer

+ Add New/Return/Transfer

25 records per page

Search:

No. of application	Name of user	Name of PI	Date of application	Review Status	Next
No data available in table					

Showing 0 to 0 of 0 entries

Previous Next

Withdrawal

New/Return/Transfer

+ Add New/Return/Transfer

25 records per page

Search:

No. of application	Name of user	Name of PI	Date of application	Review Status	Next
	湯賢賢	湯于賢		Waiting for PI's approval	Contents Withdrawal

Showing 1 to 1 of 1 entries

Previous 1 Next



PI Approval (notice email)

計畫主持人您好：

您有一筆動物房使用申請表待簽核，請點擊下方按鈕進行簽核，謝謝！

前往簽核

Regards,
ASCore動物

Click the approval button



Result

Housing area application

- Notice by email
- If the application has been approved, please reply with the shipment number

New/Return/Transfer

- Notice by email
- If the application has been approved, please return the assigned cages.



Complete work notice

動物房使用紀錄通知

申請案號： 20190128-003	計畫主持人： ██████████
申請人姓名： ██████████	申請項目： 轉移/新增籠位（含分籠）/歸還籠位

新增 B3區 籠位 完成日期： 2019-03-19

新增籠號： B3-1-A-1,B3-1-A-2,B3-1-A-3,B3-1-A-4,B3-1-A-5,B3-1-A-6,B3-1-A-7,B3-1-B-1,B3-1-B-2,B3-1-B-3

實際籠數： 10

*說明： ▲ 為使用中的籠位

B3區 B3-1 籠架

R面	1	2	3	4	5	6	7
A	新增	新增	新增	新增	新增	新增	新增
B	新增	新增	新增				
C							
D							
E							
F							
G							
H							
I							
J							



Fee Charging notice (1)

- The system will send an email to the contact person of PI for the confirmation.

您好，

在此通知您確認費用：

確認費用紀錄

Regards,
ASCORE動物房管理系統

主持人使用費用統計

計畫主持人：湯于賢

主持人確認：尚未確認

聯絡人：湯賢賢

聯絡人確認：尚未確認

聯絡電話：02-27899911

使用統計區間：2019-03-01 ~ 2019-03-06

下載使用統計

一、代養費總計：1980 元

代養區域	累積籠數	單價	小計
繁殖區A	42	10	420
繁殖區B1	84	10	840
繁殖區B2	72	10	720

二、著袍耗材費總計：0 元

姓名	使用次數	單價	小計
----	------	----	----

三、檢驗費總計：0 元

檢驗隻數	單價	小計
0	2000	0

總費用：1980 元

已確認費用內容，請確認

Fee Charging notice (2)

- After confirmed with PI, the system will send an email notify about the final charge.

主持人使用費用統計			
計畫主持人：湯于賢	主持人確認：尚未確認		
聯絡人：湯賢賢	聯絡人確認：已確認		
聯絡電話：02-27899911			
使用統計區間：2019-03-01 ~ 2019-03-06			
下載使用統計			
一、代養費總計：1980 元			
代養區域	累積籠數	單價	小計
繁殖區A	42	10	420
繁殖區B1	84	10	840
繁殖區B2	72	10	720
二、著袍耗材費總計：0 元			
姓名	使用次數	單價	小計
三、檢驗費總計：0 元			
檢疫隻數	單價	小計	
0	2000	0	
總費用：1980 元			已確認費用內容



繁殖卡
Breeding

正面
Front

Breeding Cage		Rack : _____			
		Cage : _____			
IACUC: _____					
Inst. : _____	Date: _____				
PI: _____	User: _____				
Phone: _____	Source: _____				
Sex : _____ ♂	DOB: _____				
Sex : _____ ♀	DOB: _____				
Strain : _____					
PG	DOB	NO	DOW	♂	♀

反面 Back
(右上角註記供辨識
Mark on the right.)

Breeding Cage		Rack : _____			
		Cage : _____			
IACUC: _____					
Inst. : _____	Date: _____				
PI: _____	User: _____				
Phone: _____	Source: _____				
Sex : _____ ♂	DOB: _____				
Sex : _____ ♀	DOB: _____				
Strain : _____					
PG	DOB	NO	DOW	♂	♀

一般卡
Stocking

Stock Cage		Rack : _____
		Cage : _____
IACUC: _____		
Inst. : _____	Date: _____	
PI: _____	User: _____	
Phone: _____	Source: _____	
Sex : _____ ♂	DOB: _____	
Sex : _____ ♀	DOB: _____	
Strain : _____		
Comment : _____		

Stock Cage		Rack : _____
		Cage : _____
IACUC: _____		
Inst. : _____	Date: _____	
PI: _____	User: _____	
Phone: _____	Source: _____	
Sex : _____ ♂	DOB: _____	
Sex : _____ ♀	DOB: _____	
Strain : _____		
Comment : _____		

紅框內資訊務必填齊全
Write down the
information correctly.

Breeding Cage		Rack : <u>A - 2</u>			
		Cage : <u>C 8</u>			
IACUC: 2018-R501-XXX					
Inst. : 生醫所	Date: 2019/01/02				
PI: 王毓權	User: 楊東一				
Phone: 2789-9911	Source: 國家動物中心				
Sex : <u>1</u> ♂	DOB: 2018/09/10				
Sex : <u>2</u> ♀	DOB: 2018/09/10				
Strain : C57BL/6J					
PG	DOB	NO.	DOW	♂	♀
懷孕日期 或 配種期間	出生日期	數量	離乳日期	實際離乳公母	

使用完畢請用 X 註記
Mark "X" after use.

Breeding Cage		Rack : <u>A - 2</u>			
		Cage : <u>C 8</u>			
IACUC: 2018-R501-XXX					
Inst. : 生醫所	Date: 2019/01/02				
PI: 王毓權	User: 楊東一				
Phone: 2789-9911	Source: 國家動物中心				
Sex : <u>1</u> ♂	DOB: 2018/09/10				
Sex : <u>2</u> ♀	DOB: 2018/09/10				
Strain : C57BL/6J					
PG	DOB	NO.	DOW	♂	♀
懷孕日期 或 配種期間	出生日期	數量	離乳日期	實際離乳公母	



IACUC計劃編號
IACUC No.

籠內請填實際隻數
The exact number of mice

Breeding Cage		Rack : <u>A - 2</u>			
		Cage : <u>C 8</u>			
IACUC: 2018-R501-XXX					
Inst. : 生醫所	Date: 2019/01/02				
PI: 王毓權	User: 楊東一				
Phone: 2789-9911	Source: 國家動物中心				
Sex	<u>1</u> ♂	DOB: 2018/09/10			
	<u>2</u> ♀	DOB: 2018/09/10			
Strain : C57BL/6J					
PG	DOB	NO.	DOW	♂	♀
懷孕日期 或 配種日期	出生日期	數量	離乳日期	實際離乳公母	

鼠盒位置務必填寫正確，以免拿錯別家老鼠...

Please write down rack position correctly

Rack	架號
Cage	位置
IACUC	計劃編號
Inst.	單位
Date	設卡日期
PI	計劃主持人
User	使用者
Phone	聯絡電話
Source	來源
Sex	性別
Strain	品系

紅字為必要資訊，務必填寫正確
Required information.



The regulations of AS core quarantine

- **Policy:** Animals which show negative result on the health report are able to undergo quarantine. Animals will be sent to NLAC for embryo rederivation if the animal come with risk of infection in the health report
- **Object :** Subject mice (3 weeks), Sentinel mice (5 weeks)
- **Testing Unit :** National Laboratory Animal Center
- **Sampling :** **5% of each strain or each population**

Pass : Enter AS Core

Failed: Send to NLAC for embryo rederivation or return to users



Specific Pathogen Free (SPF) List

		area A	area B
Item		A區 / 檢疫室	B區
Serology	Mycoplasma pulmonis	○	○
	Lymphocytic choriomeningitis virus	○	○
	Pneumonia virus of mice	○	○
	Sendai virus	○	○
	Theiler's murine encephalomyelitis virus (TMEV, GD VII)	○	○
	Ectromelia virus	○	○
	Hantaan virus	○	○
	Reovirus 3	○	○
	Mouse adenovirus	○	○
	Mouse hepatitis virus	○	○
	Mouse parvovirus	○	○
	Minute virus of mice	○	○
	Epizootic diarrhea of infant mice virus	○	×
	Encephalitozoon cuniculi	○	×
	Murine norovirus	○	○
	Polyoma virus	○	×
	Microbiology	Bordetella bronchiseptica	○
Corynebacterium kutscheri		○	○
Klebsiella pneumoniae		○	×
Pasteurella pneumotropica		○	×
Pseudomonas aeruginosa		○	×
Staphylococcus aureus		○	○
Streptococcus pneumoniae		○	×
Klebsiella oxytoca		○	×
Streptococcus equi subsp. Zooepidemicus		○	×
β-hemolytic Streptococcus		○	×
Pseudomonas aeruginosa		○	○
Salmonella spp.		○	○
Klebsiella oxytoca		○	×
Klebsiella pneumoniae		○	×
Campylobacter jejuni		○	×
Clostridium piliforme		○	○
Pneumocystis murina		○	○
Helicobacter spp.	○	○	
Parasitology	Exoparasite : Flea ` Louse ` Mite	○	○
	Pinworm : Syphacia spp.	○	○
	Protozoa : Chilomastix spp., Ciliates, Eimeria spp., Entamoeba spp., Giardia spp., Hexamastix spp., Other flagellates, Spiroplasma spp., Trichomonads °	○	○
	Nematoda : Aspiculuris spp., Hymenolepis diminuta, Rodentolepis nana °	○	○

Area A: 45 items.
Required quarantine

Area B:
35 items.
Animals from NLAC and BioLasco are allowed to enter area B without quarantine.



How to transport animals in and out of AS core?

Animal entering the room: the staff will handle the mouse entering the room.

Out of the room: Transport via (1) the transport carton (only for transportation in Academia Sinica area), or (2) the special transport cage (box) and carry it out through the transfer box.

If the animal is moved to other laboratories, please fill out the **Animal Transfer Application Form**.

#The cart, cages, utensils and equipment shall not take out from the unit without permission.

(Notice) Once the animal leave the AS breeding room, it is **required to quarantine again** before re-entering the animal room!!!



How to handle the escaping animal

Definition of escaped animals:

Handling mice should be operated in BSC. Once the animals flee the barrier of BSC, it is regarded as an escaped animal.

Suggestions to escaped animals:

- (1) Take the animals back to users' lab by **transport carton**.
- (2) Disinfect the escaped animals first and isolate them in a new cage/rack. Animals are OK to return after 3 weeks of health monitoring, if there is no any infection.
- (3) Euthanasia by CO₂



What should I do when mice are sick/death?

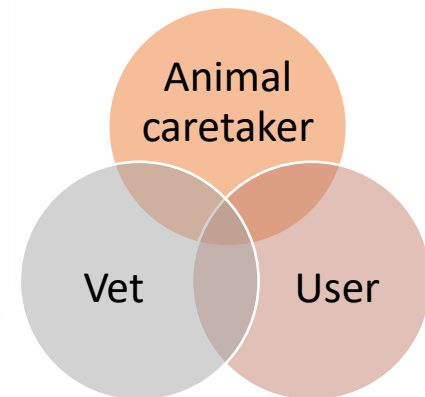
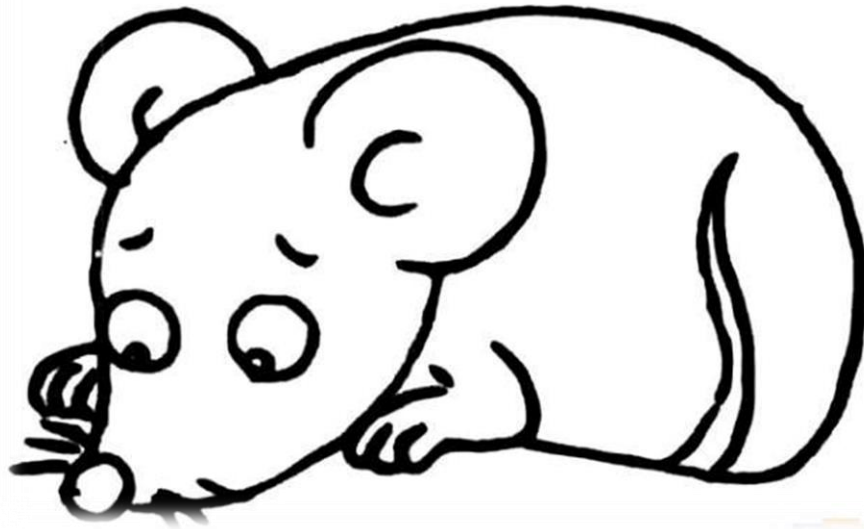

Notice of animal abnormality/death

1. Weaning over 28 days
2. Notice of Cage returning
3. Notice of completion of animal settlement
4. New cage application
5. Finding abandoned animal in cage
6. Using duplex cage for reproduction
7. Incompletion of mouse card
8. Incorrect location of vacant cage
9. Notice of abnormality
10. Notice of death
11. Notice for teeth trimming
12. Notice of euthanasia
13. Notice of separation
14. Notice of internal examination



Mice abnormal/Death Report- User's

Abnormal:

Can notify to the veterinarian for assistance

Death:

Please put the corpse in a **paper bag** in a BSC, then seal it in **zipper bag**, write down the researcher's name, rack number, cage position, date and time on the outside of the bag.

Can be put it in the **-20 °C refrigerator or take it back to user's laboratory.**



Response to pathogen outbreak

1. AS core will notify to PI, **and sacrifice the infected animals within 3 days.** The rack and vivarium will be disinfected.
2. After the infected animal is removed, the laboratory animal and user will continue to control access/operation and follow-up inspection for at least 6 months (the inspection duration will be adjusted by the veterinarian and manager depending on the type of pathogen and infection) until there is no longer pathogen contamination.
3. If the animals in the infected area are important mice, the user must take the initiative to contact the veterinarian. Within a two-week period, all of them should be removed from the AS core and transferred to other animal room that are allowed to be surrogate, or they can be commissioned by the NLAC for derivation. After the pathogen is confirmed to be cleared, it can be returned to the AS core..
4. All users should **attend the training course again.** Personal pass the course will be authorized again after training course.



Outline:

- AS Core's Organization chart and Spatial Planning
- Application for Experiment Animals
- **Application for Users**

Step 1: Training course

Step 2: Practice course (choose A or/and B)



Users apply for admission process

Take the user's Training course

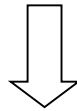

Practice course
Choose Area A **or/and** Area B)

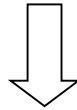

Sign the AS core user's consent and get the permission
(Personal Pass will be set to pass AS core access control)

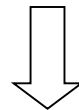

Weekend Permission application is required to enter IBMS .



Users have to know

- The light cycle of animal facility: 07:00~19:00
- User entrance time: 8:00~18:00

- User need to pass the entrance test and complete practice training. After passing, you can apply for access to the animal room with the ID card, and you can swipe your card to enter the animal room (the ID card is bound to everyone and can not be borrow/lend others).

- Weekend Permission application is required to enter IBMS.



Users have to know:

1. User **cannot** rearrange the location of cages by themselves.
2. Users **cannot** take other people who has no authorized ID pass into the animal room.
3. **It is strictly forbidden to take pictures or photographs of facility equipment.**
4. Users **cannot** ask animal caretakers to perform animal experiment, cage transfer and euthanasia.
5. Every PI has to designate one person to be a **contact person**.
6. Please come to our office to cancel the authority if not using it for a long time. It is **strictly forbidden** to pass the ID card to other users.
7. Any violation will be reported to PI and AS Core committee



Users have to know:

- The users are **not** allowed to enter the AS core within **3 days** if
 1. Users accessed other animal facilities
 2. Users performed rodent experiment in the labs
 3. Users contacted other rodents, such as pet.

- Users are not allowed to enter Area B then Area A in the same day. If users need to go area A, they must enter area A on next days.



Fees for AS Core

- **General expenses** (user committee may adjust the fees according to the actual situation)
 - (1) Basic maintenance fee: 10 NT dollars per day.
 - (2) Consumables: each entering 100 NT dollars per person
 - (3) Quarantine fee: each quarantine animal charges 2000 NT dollars

- Fee charging : **budget management and PI transfer system**
 - (1) According to the online application date, the **monthly** feeding cost is counted
 - (2) Email to the laboratory contact person and PI, and PI is signed the paper back (paper work and on-line parallel)



Other rules:

Please follow the Animal Protection Act and IACUC according to the 5R principles (**Replacement, Reduction, Refinement, Respect, Responsibility**) to do the animal experiments and make it better.

The matters that are not covered by this control and the rules must meet the requirements of the announcement of the (**IACUC**). The AS Core User Committee reserves the right of interpretation and final decision.



Reservation of instrument and equipment

The user who pass the access of AS core could make reservation for BSCs or other instruments

(<http://reservation.iis.sinica.edu.tw/servlet/SignInHandler>)

BSCs are free. IVIS 200, Xtreme II and anesthesia will be charged as below

- *IVIS : 500 NTD/hour **
- *Xtreme II : 1000 NTD/hr*
- *Anesthesia unit : 100 NTD/time*

#First application needs wait for **the qualification approval**.

#Reservation time: **One day** before use (recommended), the latest booking is one hour before use.



The location and code number of BSC and machines in AS core

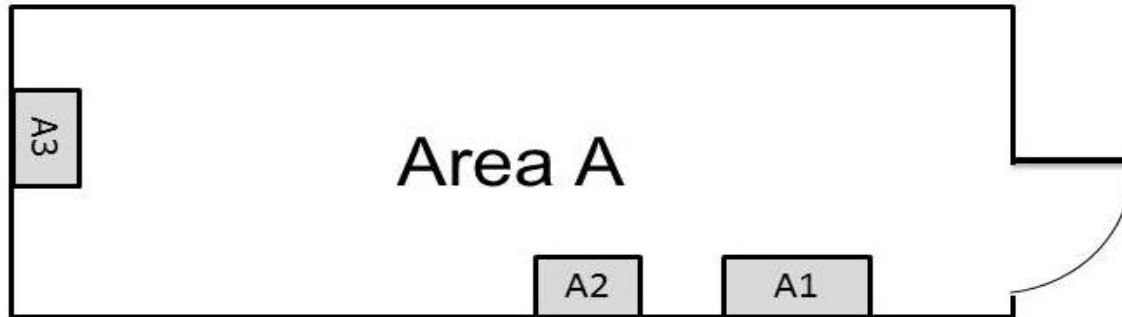

- 1.Xtreme II
- 2.IVIS2000
- 3.Anesthesia unit



The Entrance of Biological Specimen

Entrance :

Area A: Any tissue or cells specimen is **not allowed** to be taken into area A

Area B: Only the cells (tumor cell) matrix is allowed to enter area B

Exit :

Blood, mouse tail and other animal specimen have to be collected in BSC, then **sealed in the zipper bag** and take out by user or via **passing box**



How to upload/download the data of experiments or animal records in/from animal room :

Web Mail , Internet Drive (cloud)

The file can be printed in the animal room
(please delete the file after finish the work)

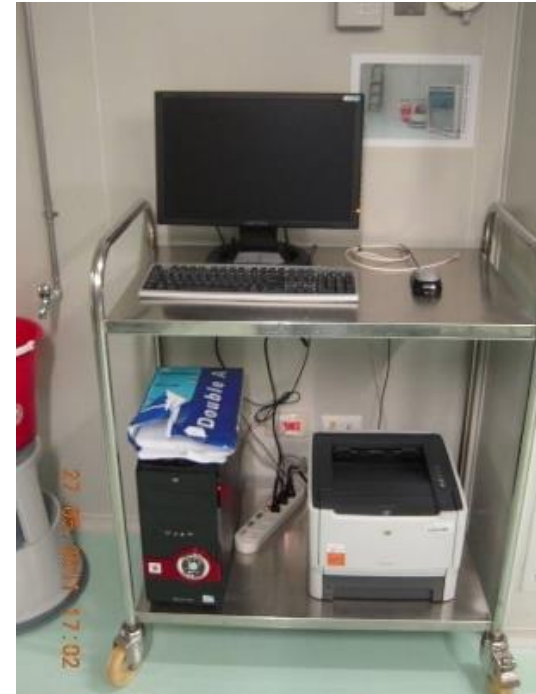

Violation

Submit to AS core Committee

- 1) First violation: users will get a “Warning Notice”.
- 2) Negligence of warning notice: a “First violation notice” will be sent to the user and his/her P.I.
- 3) Negligence of first violation notice : A “Second violation notice” will be sent to the user and belonging P.I. and report to the member of the committee of the institute and the Chairman.
- 4) Pass Card authority will be cancelled and the users need to write the violation report and take the training lecture again.
- 5) For habitual violator, the users will be forbidden permanently
- 6) Any violation of Animal Protection Act, AS Core will submit to IACUC. It has the right to terminate the experiment if necessary.

Note:

AS core has authority to keep violation records as official record for future usage



If there is any violation of the Animal Conservation Law, the facility will report to the IACUC and the animal experiment may be terminated if necessary.

Violations will be kept in AS Core as official records and also as the basis for future use rights.



Common violations

Access Control	Mouse survival welfare	Animal Room Management	Bio Safety Control
Users are still in the animal room when the access time is exceeded and did not apply in advance	Overcrowding in cages	Remove cage cars, cages, instruments, etc. from AS Core without consent	Failure to comply with the three-day use restrictions across the animal room
Unauthorized borrowing of access control card	Mice forgotten in the feed trough	Overuse unused cage	Handling infectious pathogens
	No feed	Cage not filled or emptied	Unauthorized removal of animals
	The water bottle is not placed or the water bottle is placed in the wrong position	The environment after use has not been cleaned / items are not returned	Other matters affecting animal welfare
	Late weaning	Card / Cage Information Error	
	Animals reached the ending point	No previous application for animal house (new / return / transfer / entry)	
	Other matters affecting animal welfare		



Other Policy(Based on 5R)



Capacity of the cage (housing density)

Room A:

Duplex cage -- maximal capacity is 2 mice/chamber.

Breeding in duplex cage is not allowed.

Full cage -- maximal capacity is 5 mice/cage

Room B:

Full cage -- maximal capacity is 5 mice/cage



Weaning (weaned after 21-28 days Birth)

- Activity Space
- Inbreeding
- Pheromone
- Stress
- Environmental sanitation



Feeding Limit

- Living and activity space
- Stress
- Environmental sanitation



Abnormalities (early end-up point)



Violation Case I

- **All the cart/cages/instrument/equipment is belonged to AS core. It is strictly forbidden to remove outside the facility without authorization.**



Violation-Case II



Sharp biomedical waste should not be thrown into the animal carcass bag

Keep the discussion and communication pipeline

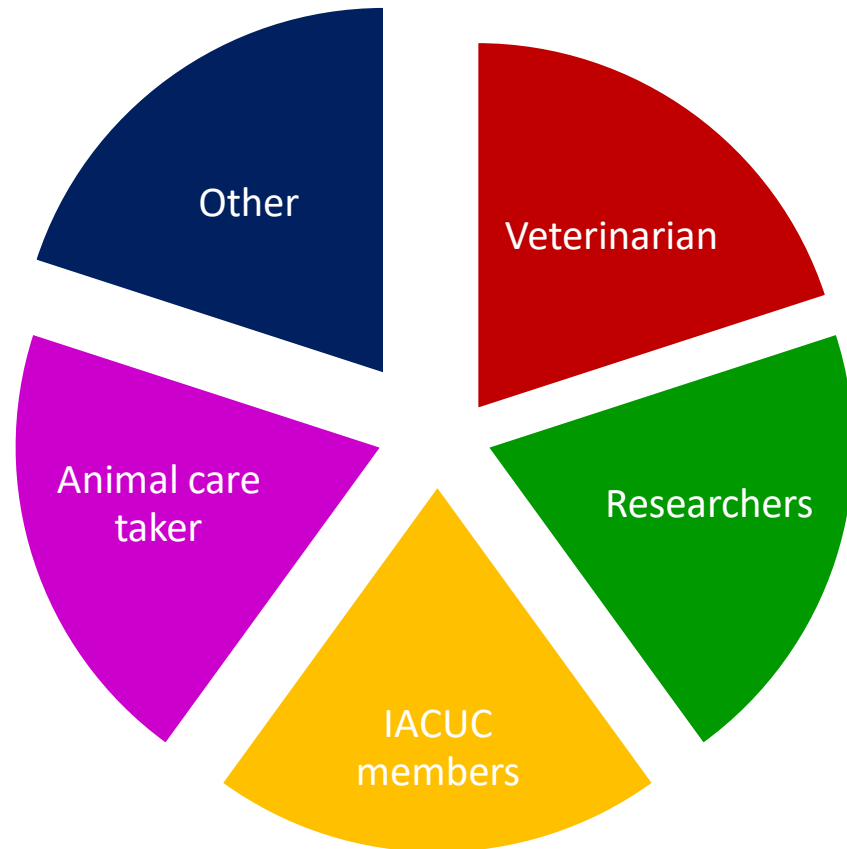

AS Core Schedule

Item	Timeline
New/Transfer/Divide/Enter application form	3 Days Before
Quarantine Time	4~8weeks (Depends on NLAC schedule)
Equipment reservation	1 Day Before
Inter-Animal room Control	3 days
Pass card Authorization Suspended	No Records within 2 months
Pass card Authorization Forbidden	No Records within 6 months
Weaning Time	Postnatal 21~28 days



Intercom and Phone Extension

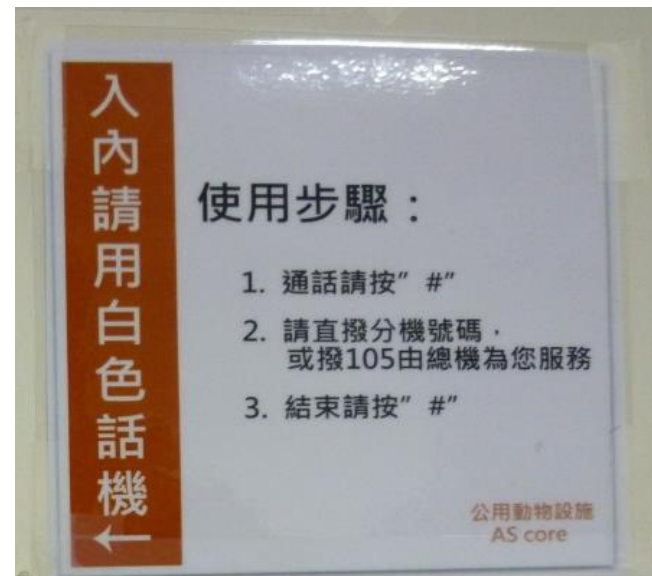

Contact us

AS core

Email: ascore@gate.sinica.edu.tw

Phone: (02)2789-9911

AS core manager

Dr. Yu-Chiuan Wang

Email:

ycwlrh@gate.sinica.edu.tw

Phone: (02)2789-9912

DVM

Yu-Huei Chen

(02)2789-9911#103

cyhwtr@gate.sinica.edu.tw



Emergency

Office :02-2789-9911 or 02-2789-9912

Security

02-2789-9999

